

GEOWEB® CELL SIZES

CELL TYPE	NOMINAL CELL AREA IN ² (MM ²)	CELL EXPANSION RANGE			
		MINIMUM LENGTH IN (MM)	MINIMUM WIDTH IN (MM)	MAXIMUM LENGTH IN (CM)	MAXIMUM WIDTH IN (CM)
20V	44.8 (289)	8.02 (204)	9.2 (234)	9.65 (245)	11.07 (281)
30V	71.3 (460)	10.25 (260)	11.39 (289)	12.39 (315)	13.77 (360)
40V	187.0 (1206)	16.92 (430)	18.01 (457)	20.66 (522)	21.88 (556)

NOTE: ALL DIMENSIONS ARE NOMINAL AND ARE WITHIN MANUFACTURING TOLERANCES

GEOWEB® SECTION SIZES

GW20V - 10 CELLS WIDE

CELLS LONG	MIN EXPANSION				MAX EXPANSION				NOMINAL AREA	
	LENGTH	WIDTH	LENGTH	WIDTH	LENGTH	WIDTH	LENGTH	WIDTH	ft ²	m ²
18	12.0	3.7	9.2	2.8	14.5	4.4	7.7	2.3	112	10.4
21	14.0	4.3			16.9	5.1			131	12.1
25	16.7	5.1			20.1	6.1			156	14.5
29	19.4	5.9			23.3	7.1			181	16.8
34	22.7	6.9			27.3	8.3			212	19.7

GW30V - 8 CELLS WIDE

CELLS LONG	MIN EXPANSION				MAX EXPANSION				NOMINAL AREA	
	LENGTH	WIDTH	LENGTH	WIDTH	LENGTH	WIDTH	LENGTH	WIDTH	ft ²	m ²
18	15.4	4.7	9.2	2.8	18.6	5.7	7.6	2.3	143	13.3
21	18.0	5.5			21.7	6.6			167	15.5
25	21.4	6.5			25.8	7.9			198	18.4
29	24.8	7.6			30.0	9.1			230	21.4
34	29.1	8.9			35.1	10.7			270	25.0

GW40V - 5 CELLS WIDE

CELLS LONG	MIN EXPANSION				MAX EXPANSION				NOMINAL AREA	
	LENGTH	WIDTH	LENGTH	WIDTH	LENGTH	WIDTH	LENGTH	WIDTH	ft ²	m ²
18	25.4	7.70	9.1	2.8	30.8	9.40	7.5	2.3	234	21.7
21	29.6	9.00			36.0	11.0			273	25.3
25	35.2	10.7			42.8	13.1			325	30.2
29	40.9	12.5			49.7	15.1			377	35.0
34	47.9	14.6			58.2	17.8			441	41.0

GEOWEB® PRODUCT CODE FORMAT
GWTVDWLL + MODIFICATIONS

WHERE:
 TT: CELL TYPE - 20, 30 or 40
 V: DESIGNATES V SERIES
 D: CELL DEPTH - 3, 4, 6, 8 or 12"
 WW: SECTION WIDTH 10 (20V); 08 (30V) & 05 (40V)
 LL: SECTION CELL LENGTH-18, 21, 25, 29 & 34

MODIFICATIONS:
 P: PERFORATED STRIP
 S1: SAND COLOR FASCIA STRIP ONLY
 G1: GREEN COLOR FASCIA STRIP ONLY
 T: INTEGRAL I-SLOT

EXAMPLE:
 GW30V60829PT
 30V CELL TYPE, 6" DEPTH, 8 CELLS WIDE, 29 CELLS LONG, PERFORATED STRIP WITH I-SLOTS

ATRA® KEY CONNECTION DETAILS

GEOWEB CONNECTION NOTES:

1. THE TOP EDGES OF ADJACENT CELL WALLS SHALL BE FLUSH WHEN CONNECTING.
2. ALIGN THE I-SLOTS FOR INTERLEAF AND END TO END CONNECTIONS.
3. THE GEOWEB PANELS SHALL BE CONNECTED WITH ATRA KEYS AT EACH INTERLEAF AND END TO END CONNECTION.

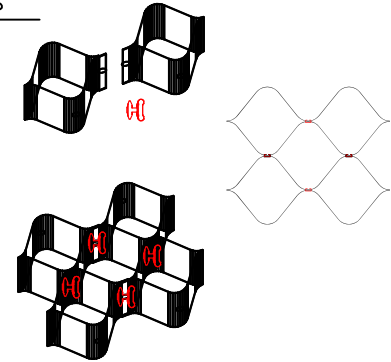

STANDARD GEOWEB® SECTION DIMENSIONS

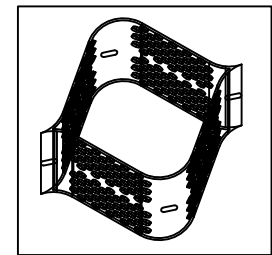
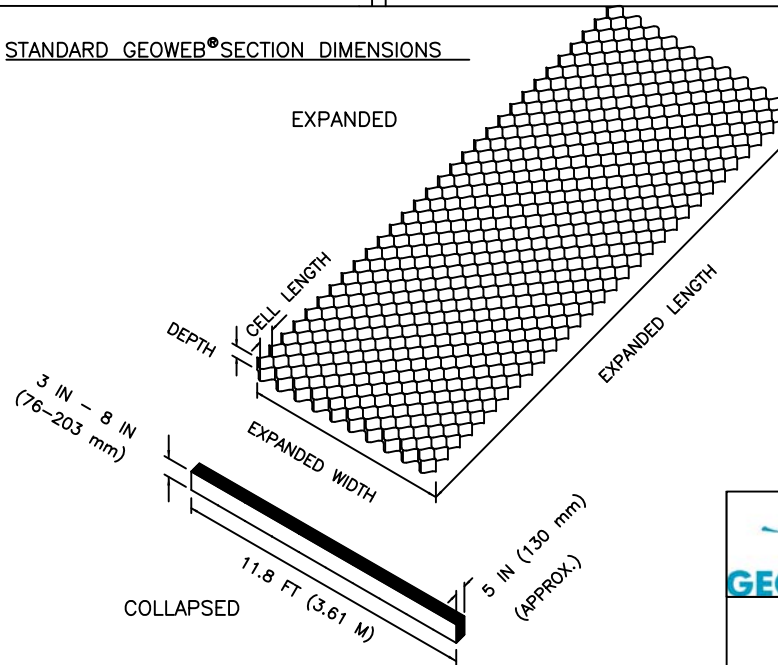

ISOMETRIC VIEW OF PERFORATED STRIP WITH I-SLOT

GEO SYSTEMS
 PRESTO® PRODUCTS CO.
 670 NORTH PERKINS STREET
 APPLETON, WI 54914
 920-738-1328
 WWW.PRESTOGEO.COM

GENUINE GEOWEB® SECTION DIMENSIONS

PRESTO®, GEOWEB®, AND ATRA® ARE REGISTERED TRADEMARKS OF PRESTO PRODUCTS.

DATE	NOVEMBER 2019	FILE NAME	GWGN1F.DWG
SCALE	NTS	SHEET	1
© 2010 PRESTO GEOSYSTEMS			

THIS DRAWING IS COPYRIGHTED AND BASED UPON THE USE OF GENUINE GEOWEB MANUFACTURED BY PRESTO GEOSYSTEMS. ANY USE OF THIS DRAWING FOR ANY PRODUCT OTHER THAN THAT MANUFACTURED BY PRESTO GEOSYSTEMS IS STRICTLY PROHIBITED.

TYPICAL STAKE ANCHORAGE SYSTEM

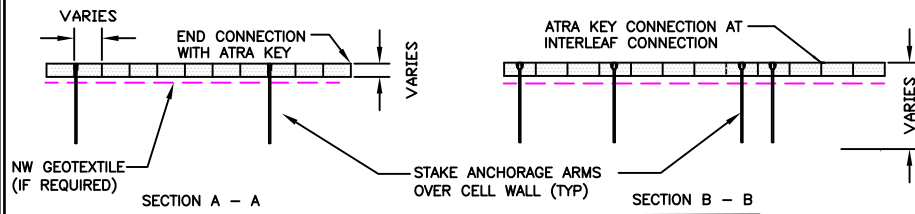
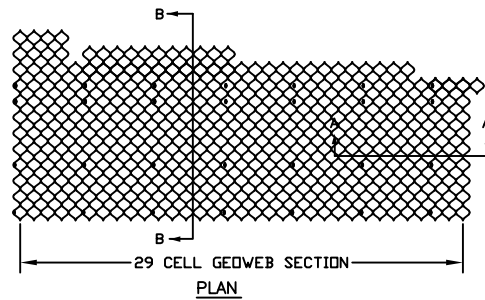

TYPICAL ATRA TENDON CLIP AND TENDON SYSTEM

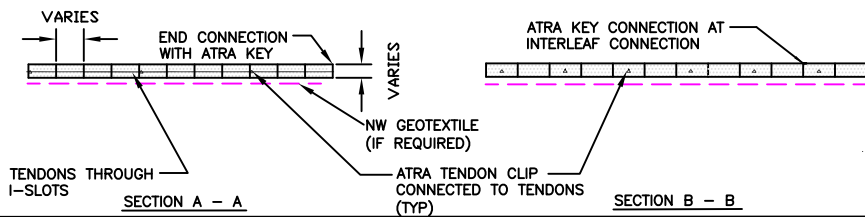
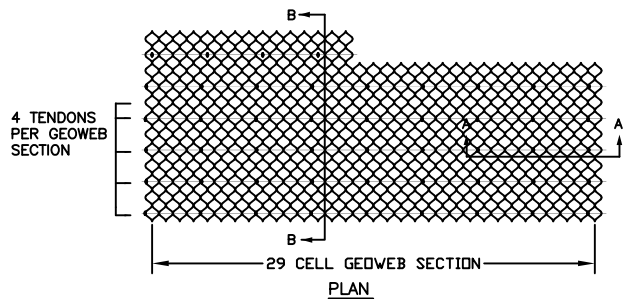

STAKE ANCHORAGE INSTALLATION – NO TENDONS

- STEPS:
1. POSITION ATRA ANCHOR OR ATRA SPEED STAKE NEXT TO UP SLOPE CELL WALL.
 2. DRIVE ATRA ANCHOR OR ATRA SPEED STAKE INTO THE GROUND UNTIL ARM OF ANCHOR IS ABOVE CELL WALL.
 3. ENGAGE ARM OF ANCHOR TO CELL WALL AND DRIVE UNTIL TIGHT.

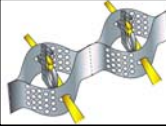

STEP 1: INSERT THE LOCKING MEMBER OF THE ATRA TENDON CLIP THROUGH THE I-SLOT IN THE CELL WALL. TURN THE CLIP 90 DEGREES TO LOCK.



STEP 2: PULL A FEW INCHES OF TENDON THROUGH THE CIRCULAR OPENING IN THE ATRA TENDON CLIP.



STEP 3: PULL THE TENDON UP AND OVER THE POST OF THE ATRA TENDON CLIP.



STEP 4: TWIST THE TENDON TO FORM A LOOP.



STEP 5: FOLD THE TENDON LOOP BACK DOWN OVER THE POST.



STEP 6: PULL THE TENDON SO THE SLACK IS ELIMINATED AND IT IS TIGHTLY SECURED TO THE CLIP.

TYPICAL TENDON TIE OFF DETAIL

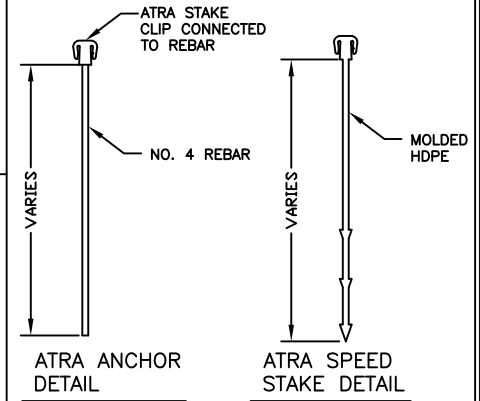

NOTES:

1. ATRA ANCHOR AND ATRA SPEED STAKE LENGTH AND SPACING VARY ACCORDING TO DESIGN REQUIREMENTS.
2. WHEN ATRA ANCHORS OR ATRA SPEED STAKES ARE USED FOR ANCHORAGE, ENSURE ANCHOR ARM ENGAGES WITH THE TOP OF THE CELL WALL.
3. TENDON TYPE AND SPACING VARY ACCORDING TO DESIGN REQUIREMENTS.
4. ATRA TENDON CLIPS, ATRA ANCHORS, OR ATRA SPEED STAKES SHALL BE PROVIDED AT END OF GEOWEB SECTION TO PREVENT TENDON FROM PULLING THROUGH THE WEB.
5. CREST ANCHORAGE WITH ATRA ANCHOR AND/OR ATRA SPEED STAKES AND/OR ATRA TENDON CLIPS/TENDONS MAY BE REQUIRED PER THE DESIGN.
6. ALL ANCHOR REQUIREMENTS SHALL BE PREPARED BY A COMPETENT PROFESSIONAL FAMILIAR WITH ENGINEERING CONCEPTS.

	PRESTO® PRODUCTS CO. 670 NORTH PERKINS STREET APPLETON, WI 54914 920-738-1328 WWW.PRESTOGEO.COM
	<p>GENUINE GEOWEB® ANCHOR DETAILS</p> <p><small>PRESTO®, GEOWEB®, AND ATRA® ARE REGISTERED TRADEMARKS OF PRESTO PRODUCTS.</small></p>

THIS DRAWING IS COPYRIGHTED AND BASED UPON THE USE OF GENUINE GEOWEB MANUFACTURED BY PRESTO GEOSYSTEMS. ANY USE OF THIS DRAWING FOR ANY PRODUCT OTHER THAN THAT MANUFACTURED BY PRESTO GEOSYSTEMS IS STRICTLY PROHIBITED.

DATE	NOVEMBER 2019	FILE NAME	GWGEN2F.DWG
SCALE	NTS	SHEET	1
© 2010 PRESTO GEOSYSTEMS			

TYPICAL BOTTOM CONNECTION TO CONCRETE STRUCTURE

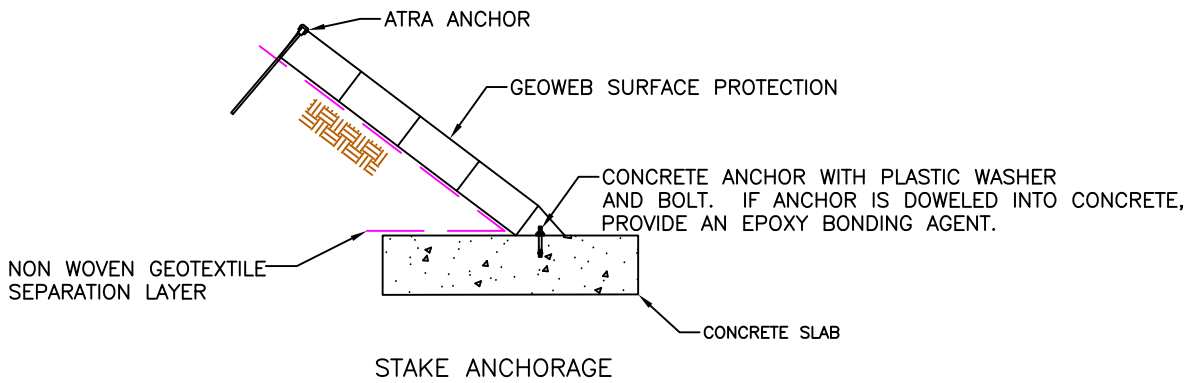
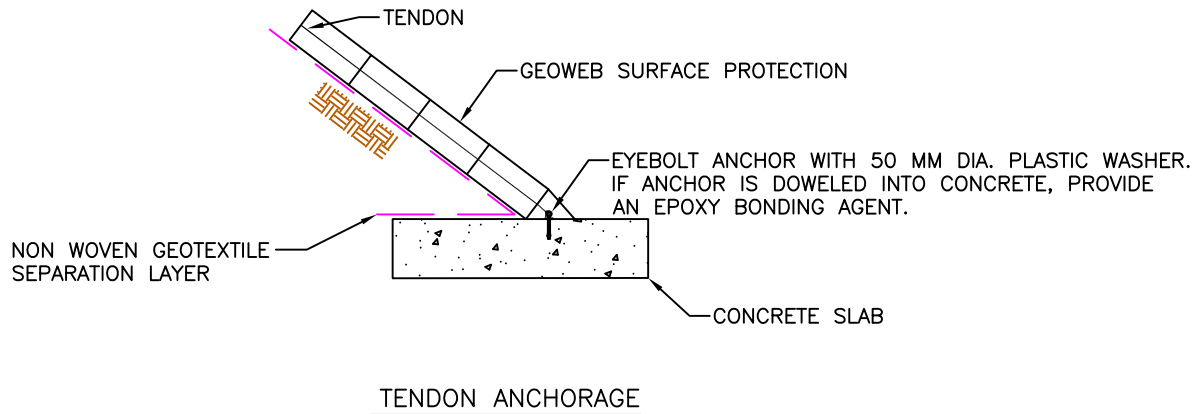

NOTES:

1. COORDINATE THE NUMBER AND LOCATION OF ATRA TENDON CLIPS AND/OR STAKE ANCHORS REQUIRED TO TRANSFER THE LOAD TO THE CREST ANCHOR SYSTEM.
2. EARTH ANCHORS SHALL BE INSTALLED PER MANUFACTURER'S REQUIREMENTS.
3. ALL CREST ANCHORAGE REQUIREMENTS SHALL BE PREPARED BY A PROFESSIONAL FAMILIAR WITH ENGINEERING CONCEPTS.
4. WHEN CONNECTING TO A CONCRETE STRUCTURE, TENDON CAN BE TIED DIRECTLY TO SPECIFIED EYE BOLT OR ROD THROUGH THE EYE BOLT.
5. INSTALL EYE BOLT PER MANUFACTURER'S INSTRUCTIONS.
6. EPOXY ANCHORING COMPOUNDED IS RECOMMENDED WHEN EYE BOLT IS DOWELED INTO AN EXISTING CONCRETE STRUCTURE.

TYP TENDON CONNECTION TO CONCRETE STRUCTURE

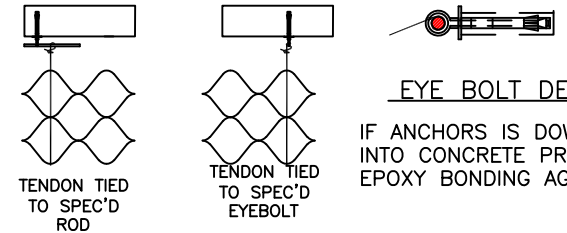

PLAN VIEW

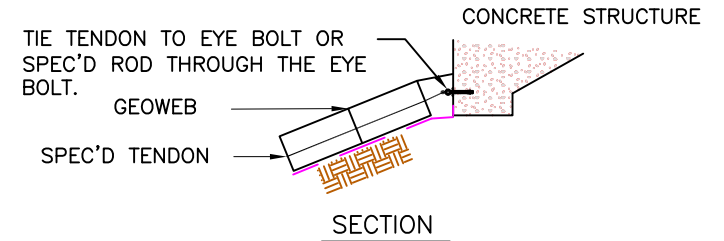

	PRESTO® PRODUCTS CO. 670 NORTH PERKINS STREET APPLETON, WI 54914 920-738-1328 WWW.PRESTOGEO.COM
	GENUINE GEOWEB® CONCRETE ANCHORAGE DETAILS

PRESTO®, GEOWEB®, AND ATRA® ARE REGISTERED TRADEMARKS OF PRESTO PRODUCTS.

THIS DRAWING IS COPYRIGHTED AND BASED UPON THE USE OF GENUINE GEOWEB MANUFACTURED BY PRESTO GEOSYSTEMS. ANY USE OF THIS DRAWING FOR ANY PRODUCT OTHER THAN THAT MANUFACTURED BY PRESTO GEOSYSTEMS IS STRICTLY PROHIBITED.

DATE	NOVEMBER 2019	FILE NAME	GWGN3AF.DWG
SCALE	NTS	SHEET	1
© 2011 PRESTO GEOSYSTEMS			

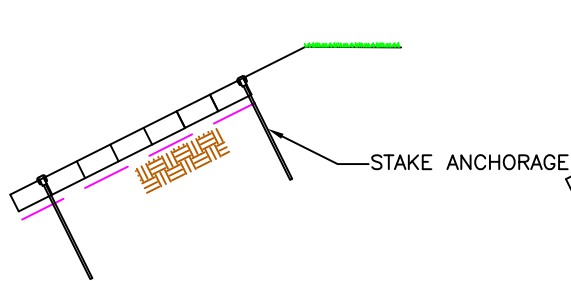

STAKE ANCHORAGE

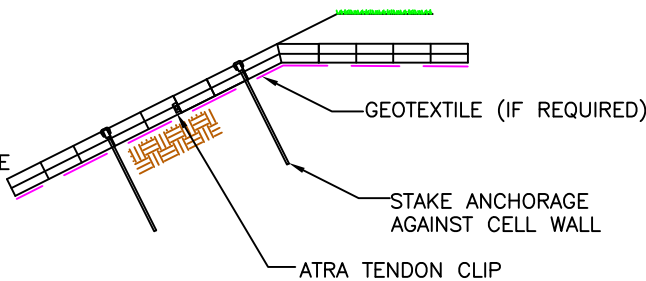

SOIL COVER/EMBEDMENT

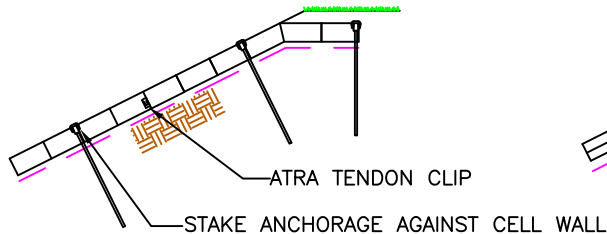

STAKE AND CREST ANCHORAGE

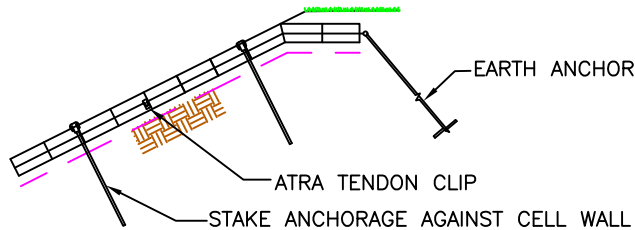

EARTH ANCHOR

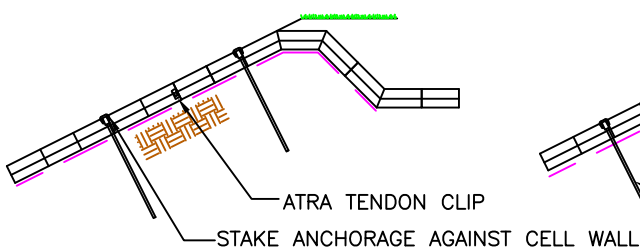

ANCHOR TRENCH

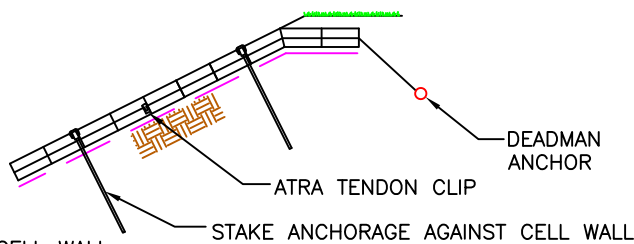

DEADMAN ANCHOR

NOTES:

1. IF TENDONS ARE REQUIRED, COORDINATE THE NUMBER AND LOCATION OF ATRA TENDON CLIPS AND/OR STAKE ANCHORAGE STAKES REQUIRED TO TRANSFER THE LOAD TO THE CREST ANCHOR SYSTEM.
2. EARTH ANCHORS SHALL BE INSTALLED PER MANUFACTURER'S REQUIREMENTS.
3. ALL CREST ANCHORAGE REQUIREMENTS SHALL BE PREPARED BY A PROFESSIONAL FAMILIAR WITH ENGINEERING CONCEPTS.
4. WHEN CONNECTING TO A CONCRETE STRUCTURE, TENDON CAN BE TIED DIRECTLY TO SPECIFIED EYE BOLT OR ROD THROUGH THE EYE BOLT.
5. INSTALL EYE BOLT PER MANUFACTURER'S INSTRUCTIONS.
6. EPOXY ANCHORING COMPOUNDED IS RECOMMENDED WHEN EYE BOLT IS DOWELED INTO AN EXISTING CONCRETE STRUCTURE.

TYPICAL CONNECTION TO CONCRETE STRUCTURE

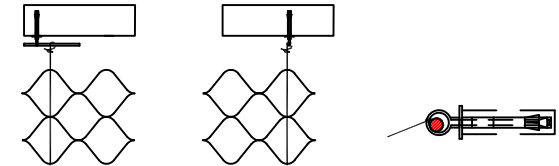

TENDON TIED TO SPEC'D ROD

TENDON TIED TO SPEC'D EYEBOLT

EYE BOLT DETAIL

PLAN VIEW

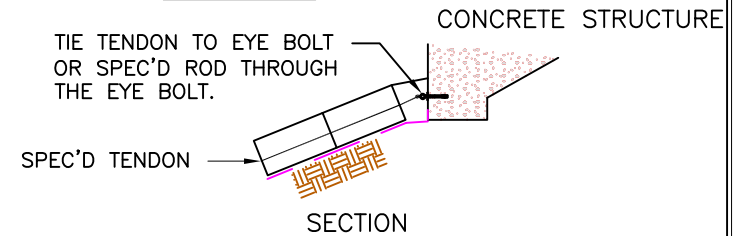

SECTION

	PRESTO® PRODUCTS CO. 670 NORTH PERKINS STREET APPLETON, WI 54914 920-738-1328 WWW.PRESTOGEO.COM
	GENUINE GEOWEB® CREST ANCHOR DETAILS

PRESTO®, GEOWEB®, AND ATRA® ARE REGISTERED TRADEMARKS OF PRESTO PRODUCTS.

THIS DRAWING IS COPYRIGHTED AND BASED UPON THE USE OF GENUINE GEOWEB MANUFACTURED BY PRESTO GEOSYSTEMS. ANY USE OF THIS DRAWING FOR ANY PRODUCT OTHER THAN THAT MANUFACTURED BY PRESTO GEOSYSTEMS IS STRICTLY PROHIBITED.

DATE	NOVEMBER 2019	FILE NAME	GWGEN3BF.DWG
SCALE	NTS	SHEET	1
		© 2010 PRESTO GEOSYSTEMS	

GEOWEB SECTION PLACEMENT AROUND EXISTING DRAIN PIPE ON SLOPE

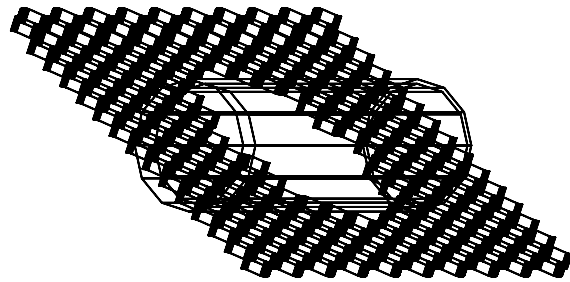

PIPE THROUGH GEOWEB SECTION

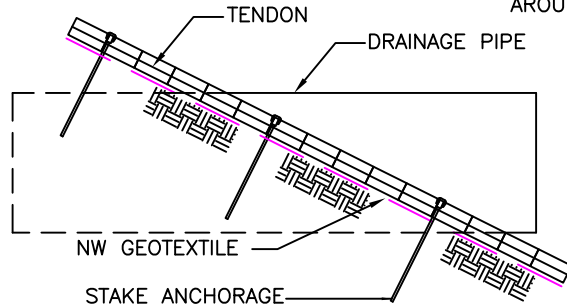

SECTION

CUT GEOWEB SECTION TO FIT AROUND THE PIPE

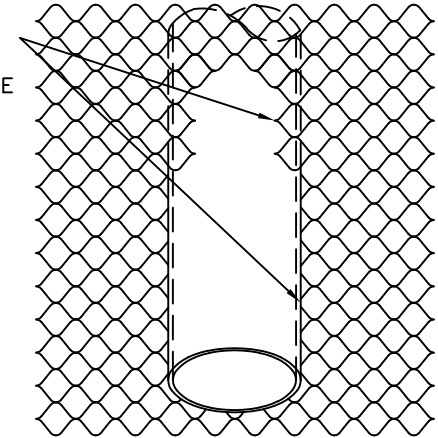

VIEW PERPENDICULAR TO SLOPE

DRAINAGE THROUGH GEOWEB RETAINING WALL

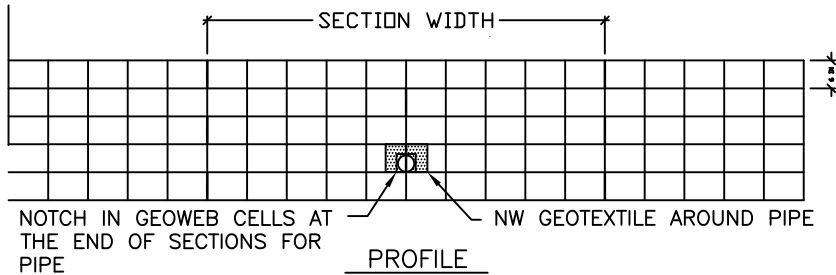

PROFILE

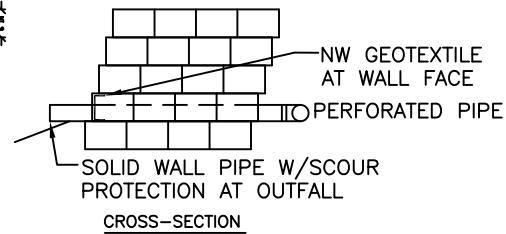

CROSS-SECTION

SPEC'D PERFORATED PIPE WRAPPED IN GEOTEXTILE @ MIN 2% SLOPE

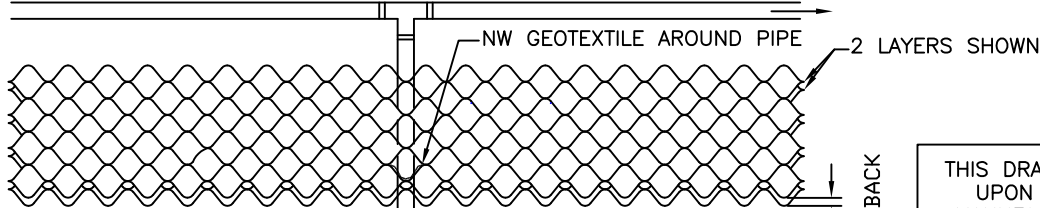

PLAN

SOLID WALL PVC PIPE THROUGH WALL AS SPEC'D. (MAX 50 FT CENTERS RECOMMENDED)

SETBACK

PRESSURE RELIEF HOLES FOR CONCRETE FILLED GEOWEB

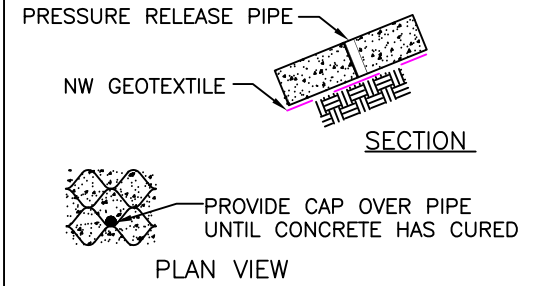

SECTION

PLAN VIEW

THIS DRAWING IS COPYRIGHTED AND BASED UPON THE USE OF GENUINE GEOWEB MANUFACTURED BY PRESTO GEOSYSTEMS. ANY USE OF THIS DRAWING FOR ANY PRODUCT OTHER THAN THAT MANUFACTURED BY PRESTO GEOSYSTEMS IS STRICTLY PROHIBITED.



PRESTO® PRODUCTS CO.
670 NORTH PERKINS STREET
APPLETON, WI 54914
920-738-1328
WWW.PRESTOGEO.COM

GENUINE GEOWEB® DRAINAGE DETAILS

PRESTO®, GEOWEB®, AND ATRA® ARE REGISTERED TRADEMARKS OF PRESTO PRODUCTS.

DATE	NOVEMBER 2019	FILE NAME	GWGEN4F.DWG
SCALE	NTS	SHEET	1
© 2010 PRESTO GEOSYSTEMS			

TEMPORARY STAKING METHOD FOR GW30V

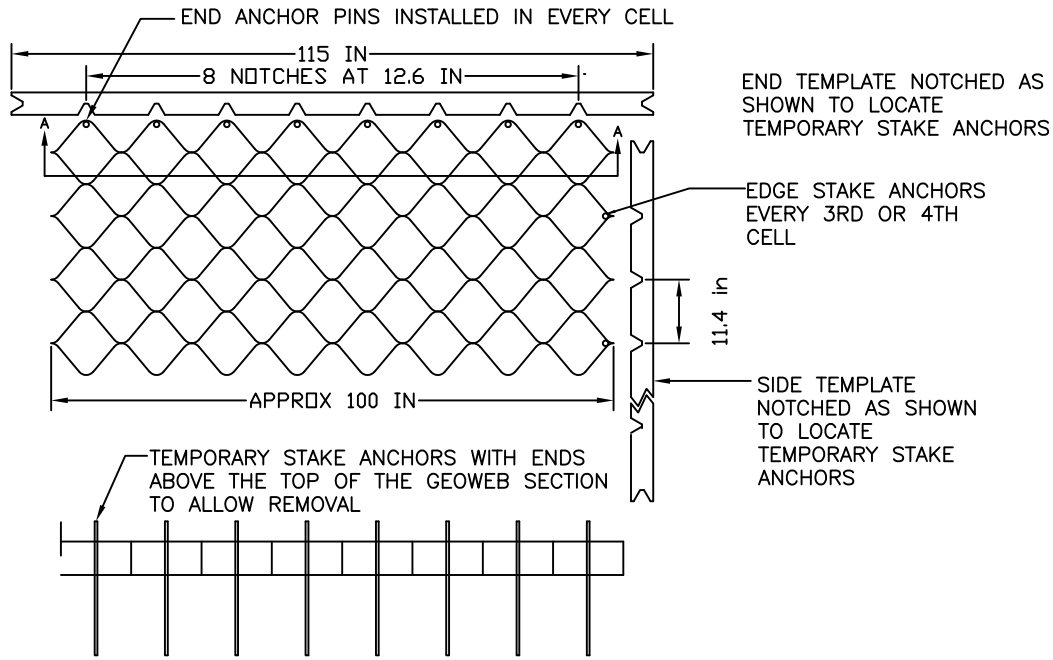

SECTION A-A

PARTS LIST FOR TEMPORARY STAKING METHOD:

1. 16 - 24" ATRA ANCHORS OR ATRA SPEED STAKES
2. 1 - END TEMPLATE FROM 2 X 4 LUMBER
3. 1 - SIDE TEMPLATE FROM 2 X 4 LUMBER

NOTES:

1. END TEMPLATES ARE USED TO ANCHOR THE ENDS OF EXPANDED GEOWEB SECTIONS.
2. NOTCHES OF END TEMPLATES ARE AT 10.2" CENTERS FOR GW20V AND 20" CENTERS FOR GW40V GEOWEB SECTIONS.
3. NOTCHES FOR SIDE TEMPLATES ARE AT 8.9" CENTERS FOR GW20V AND 18.9" FOR GW40V GEOWEB SECTIONS.

TYPICAL WOOD STRETCHER FRAME FOR GW30V

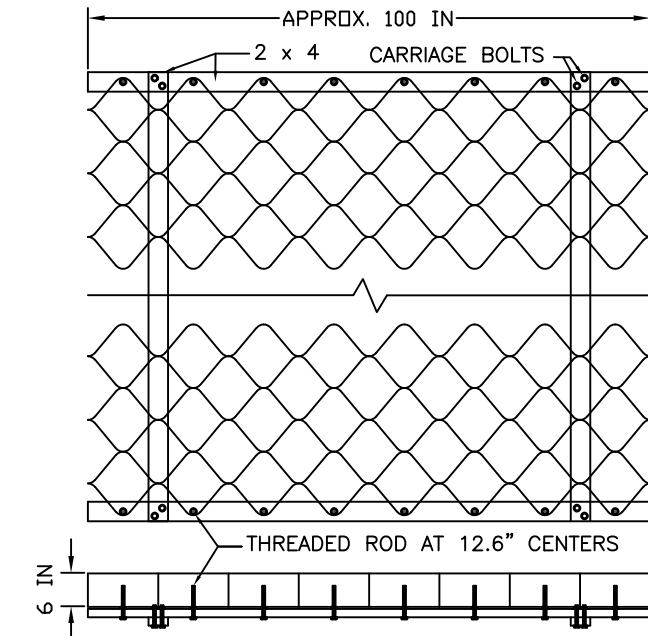

PARTS LIST FOR WOOD STRETCHER FRAME:

1. 16 - 1/2" THREADED ROD
2. 8 - 3/8" CARRIAGE BOLTS
3. 48 - FLAT WASHERS
4. 48 - HEX NUTS
5. 3 - 2 X 4 X 8 FT LUMBER

	PRESTO® PRODUCTS CO. 670 NORTH PERKINS STREET APPLETON, WI 54914 920-738-1328 WWW.PRESTOGEOWEB.COM
	GENUINE GEOWEB® INSTALLATION TOOLS

PRESTO®, GEOWEB®, AND ATRA® ARE REGISTERED TRADEMARKS OF PRESTO PRODUCTS.

DATE	NOVEMBER 2019	FILE NAME	GWGEN5F.DWG
SCALE	NTS	SHEET	1
© 2010 PRESTO GEOSYSTEMS			

THIS DRAWING IS COPYRIGHTED AND BASED UPON THE USE OF GENUINE GEOWEB MANUFACTURED BY PRESTO GEOSYSTEMS. ANY USE OF THIS DRAWING FOR ANY PRODUCT OTHER THAN THAT MANUFACTURED BY PRESTO GEOSYSTEMS IS STRICTLY PROHIBITED.

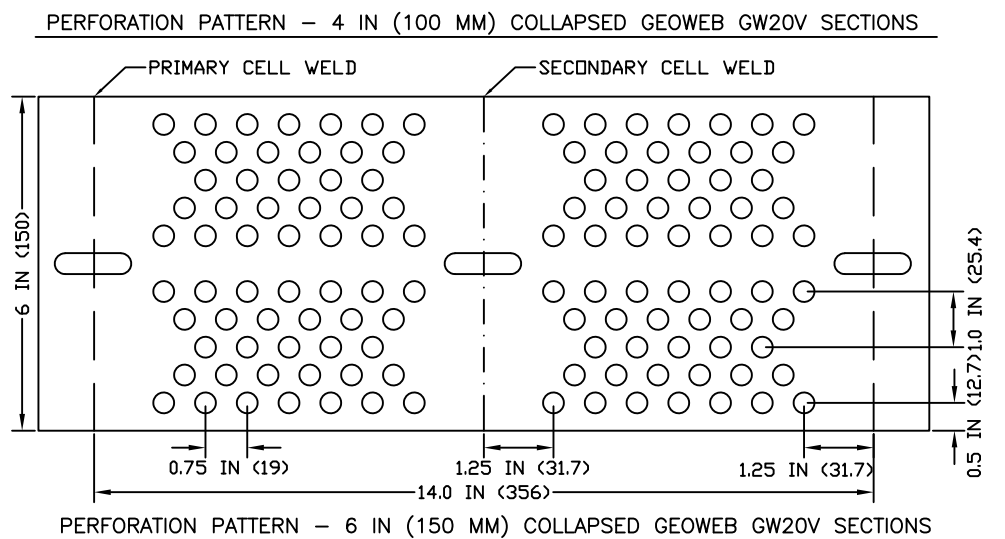
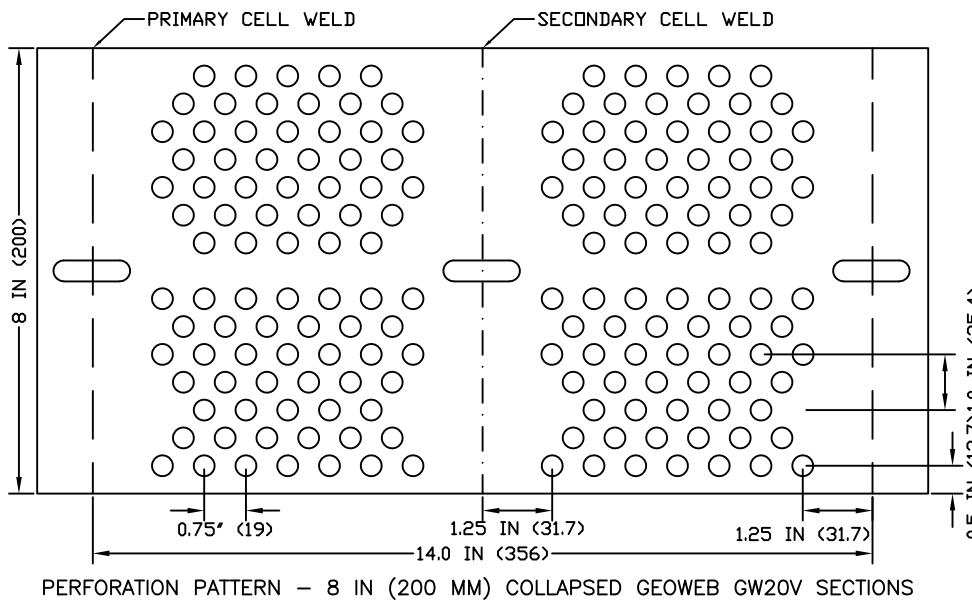
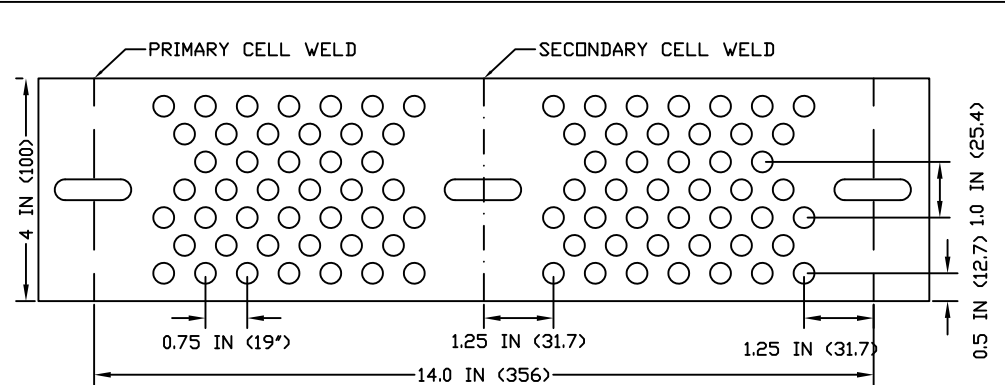
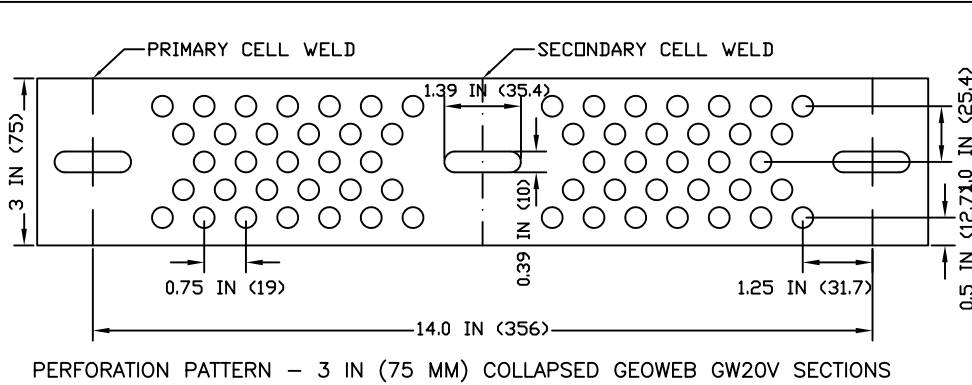

PRESTO® PRODUCTS CO.
670 NORTH PERKINS STREET
APPLETON, WI 54914
920-738-1328
WWW.PRESTOGEOSYSTEMS.COM

- NOTES:
1. CENTER I-SLOT ON PRIMARY AND SECONDARY WELDS.
 2. ALL PERFORATIONS ARE 0.39" (10MM) DIAMETER.
 3. GEOWEB CELL OPEN AREA = 21.2% PLUS/MINUS 1.0%.
 4. DIMENSIONS ARE SUBJECT TO MANUFACTURER'S TOLERANCES.
 5. DIMENSIONS IN () ARE MILLIMETERS.
 6. ALL DIMENSIONS ARE SUBJECT TO MANUFACTURER'S TOLERANCES.

GEOWEB CELL DEPTH	# OF PERFORATIONS IN A SINGLE GW20V CELL
8 IN (200 MM)	344
6 IN (150 MM)	248
4 IN (100 MM)	176
3 IN (75 MM)	124

THIS DRAWING IS COPYRIGHTED AND BASED UPON THE USE OF GENUINE GEOWEB MANUFACTURED BY PRESTO GEOSYSTEMS. ANY USE OF THIS DRAWING FOR ANY PRODUCT OTHER THAN THAT MANUFACTURED BY PRESTO GEOSYSTEMS IS STRICTLY PROHIBITED.

GENUINE GEOWEB® 20V CELLULAR CONFINEMENT SYSTEM PERFORATIONS

GEOSYSTEMS® GEOWEB® AND ATRA® ARE REGISTERED TRADEMARKS OF PRESTO PRODUCTS COMPANY.

DATE	NOVEMBER 2019	FILE NAME	GWGEN6AF.DWG
SCALE	NTS	SHEET	1

© 2011 PRESTO GEOSYSTEMS

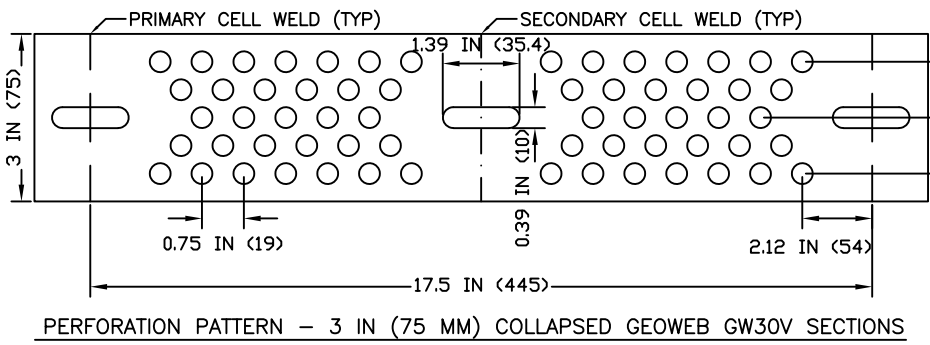

PERFORATION PATTERN - 3 IN (75 MM) COLLAPSED GEOWEB GW30V SECTIONS

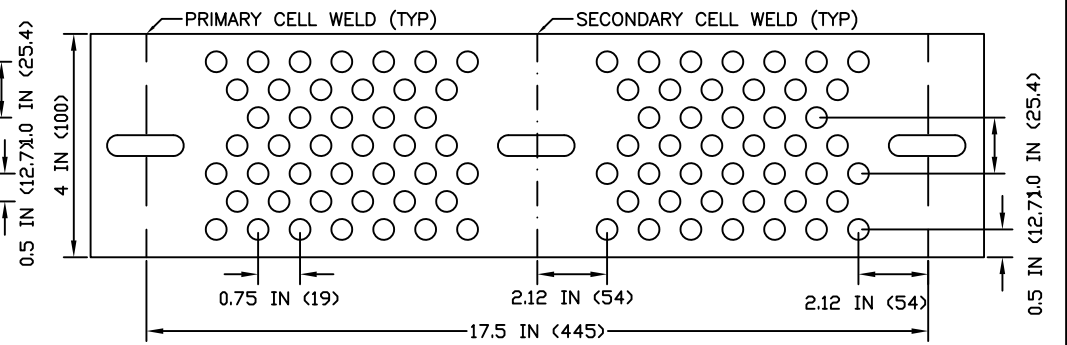

PERFORATION PATTERN - 4 IN (100 MM) COLLAPSED GEOWEB GW30V SECTIONS

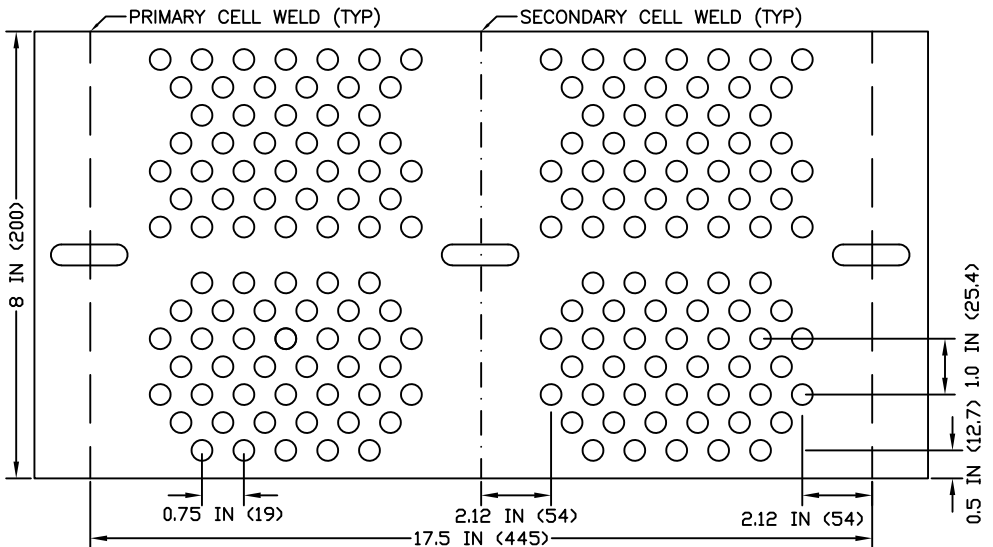

PERFORATION PATTERN - 8 IN (200 MM) COLLAPSED GEOWEB GW30V SECTIONS

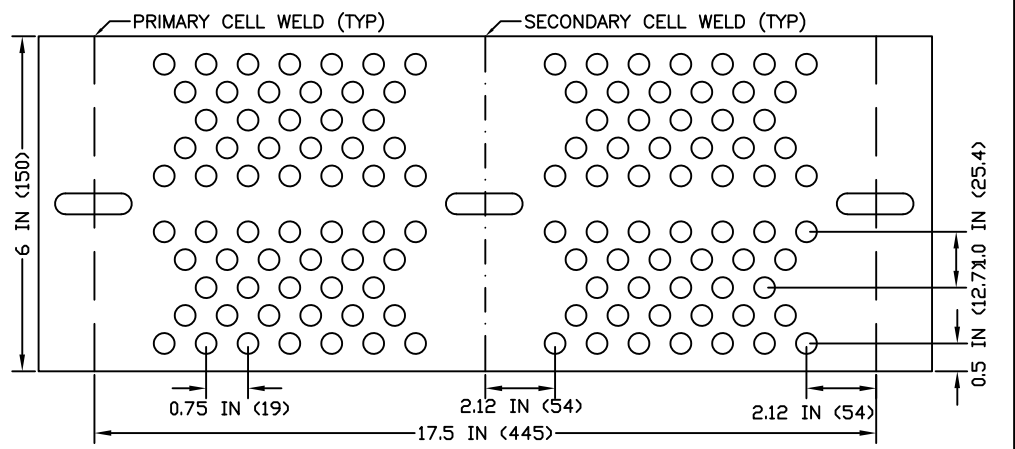

PERFORATION PATTERN - 6 IN (150 MM) COLLAPSED GEOWEB GW30V SECTIONS

- NOTES:
1. CENTER I-SLOT ON PRIMARY AND SECONDARY WELDS.
 2. ALL PERFORATIONS ARE 0.39" (10MM) DIAMETER.
 3. GEOWEB CELL OPEN AREA = 16.8% PLUS/MINUS 1.0%.
 4. DIMENSIONS ARE SUBJECT TO MANUFACTURER'S TOLERANCES.
 5. DIMENSIONS IN () ARE MILLIMETERS.

GEOWEB CELL DEPTH	# OF PERFORATIONS IN A SINGLE GW30V CELL
8 IN (200 MM)	344
6 IN (150 MM)	248
4 IN (100 MM)	176
3 IN (75 MM)	124

THIS DRAWING IS COPYRIGHTED AND BASED UPON THE USE OF GENUINE GEOWEB MANUFACTURED BY PRESTO GEOSYSTEMS. ANY USE OF THIS DRAWING FOR ANY PRODUCT OTHER THAN THAT MANUFACTURED BY PRESTO GEOSYSTEMS IS STRICTLY PROHIBITED.

PRESTO[®] PRODUCTS CO.
 670 NORTH PERKINS STREET
 APPLETON, WI 54914
 920-738-1328
 WWW.PRESTOGEO.COM

GENUINE GEOWEB[®] 30V
 CELLULAR CONFINEMENT SYSTEM
 PERFORATIONS

GEOSYSTEMS[®], GEOWEB[®] AND ATRA[®] ARE REGISTERED TRADEMARKS OF PRESTO PRODUCTS COMPANY.

DATE	NOVEMBER 2019	FILE NAME	GWGEN6BF.DWG
SCALE	NTS	SHEET	1

© 2011 PRESTO GEOSYSTEMS

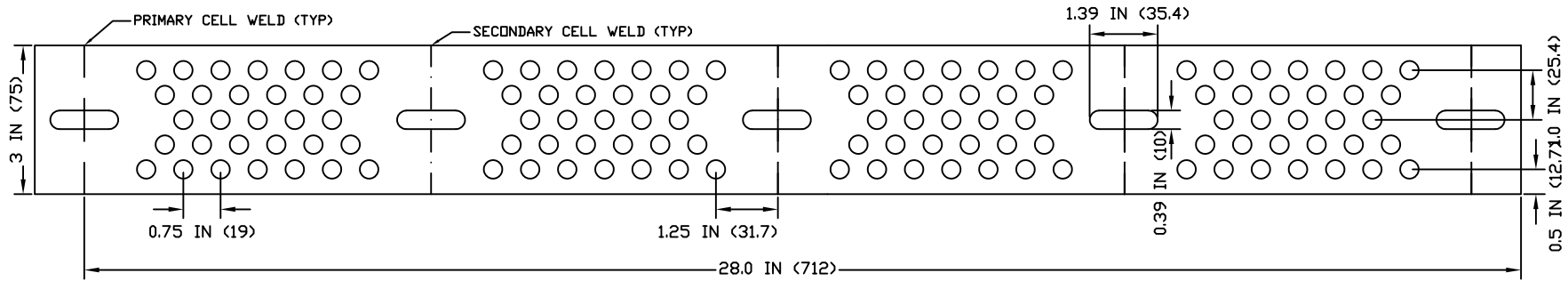

PERFORATION PATTERN - 3 IN (75 MM) COLLAPSED GEOWEB GW40V SECTIONS

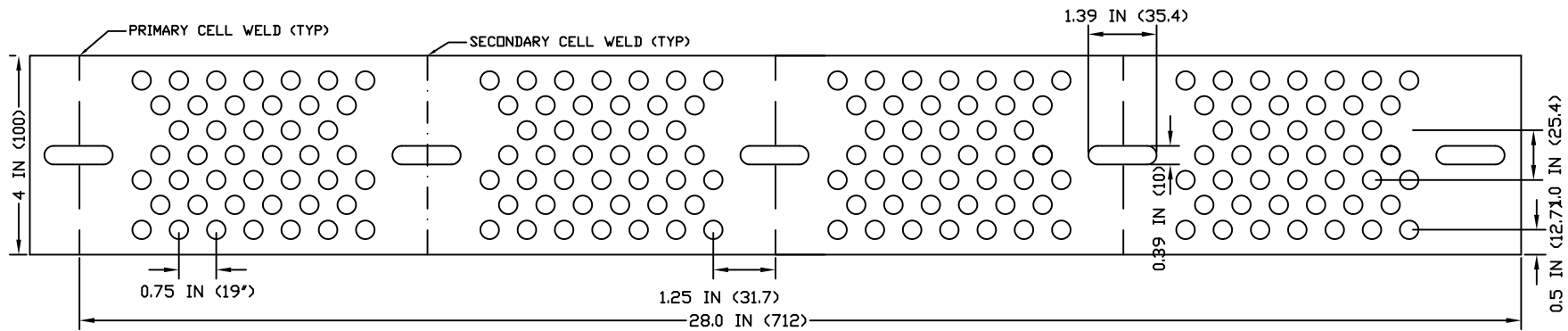

PERFORATION PATTERN - 4 IN (100 MM) COLLAPSED GEOWEB GW40V SECTIONS

NOTES:

1. CENTER I-SLOT ON PRIMARY AND SECONDARY WELDS.
2. ALL PERFORATIONS ARE 0.39" (10MM) DIAMETER.
3. GEOWEB CELL OPEN AREA = 19.8% PLUS/MINUS 1.0%.
4. DIMENSIONS ARE SUBJECT TO MANUFACTURER'S TOLERANCES.
5. DIMENSIONS IN () ARE MILLIMETERS.

GEOWEB CELL DEPTH	# OF PERFORATIONS IN A SINGLE GW20V CELL
8 IN (200 MM)	688
6 IN (150 MM)	496
4 IN (100 MM)	352
3 IN (75 MM)	248

THIS DRAWING IS COPYRIGHTED AND BASED UPON THE USE OF GENUINE GEOWEB MANUFACTURED BY PRESTO GEOSYSTEMS. ANY USE OF THIS DRAWING FOR ANY PRODUCT OTHER THAN THAT MANUFACTURED BY PRESTO GEOSYSTEMS IS STRICTLY PROHIBITED.

	PRESTO® PRODUCTS CO. 670 NORTH PERKINS STREET APPLETON, WI 54914 920-738-1328 WWW.PRESTOCEO.COM	
	GENUINE GEOWEB® 40V 3 & 4 INCH CELLULAR CONFINEMENT SYSTEM PERFORATIONS <small>GEOSYSTEMS®, GEOWEB® AND ATRA® ARE REGISTERED TRADEMARKS OF PRESTO PRODUCTS COMPANY.</small>	
DATE	NOVEMBER 2019	FILE NAME GWGEN6CF.DWG
SCALE	NTS	SHEET 1 © 2011 PRESTO GEOSYSTEMS

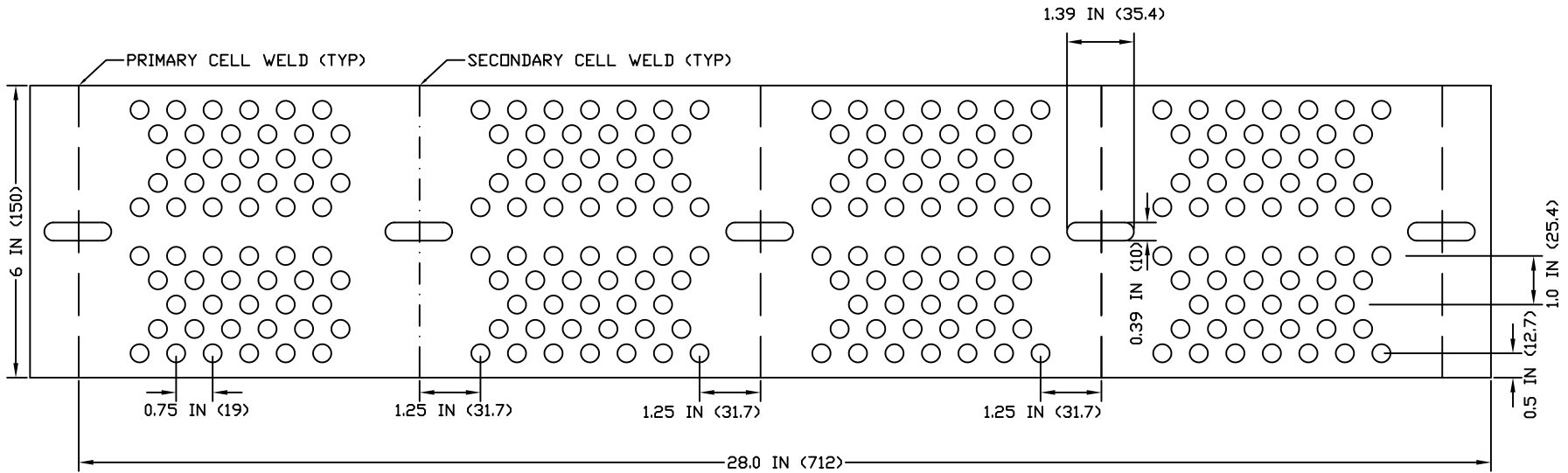

PERFORATION PATTERN - 6 IN (150 MM) COLLAPSED GEOWEB GW40V SECTIONS

NOTES:

1. CENTER I-SLOT ON PRIMARY AND SECONDARY WELDS.
2. ALL PERFORATIONS ARE 0.39" (10MM) DIAMETER.
3. GEOWEB CELL OPEN AREA = 19.8% PLUS/MINUS 1.0%.
4. DIMENSIONS ARE SUBJECT TO MANUFACTURER'S TOLERANCES.
5. DIMENSIONS IN () ARE MILLIMETERS.

GEOWEB CELL DEPTH	# OF PERFORATIONS IN A SINGLE GW20V CELL
8 IN (200 MM)	688
6 IN (150 MM)	496
4 IN (100 MM)	352
3 IN (75 MM)	248

THIS DRAWING IS COPYRIGHTED AND BASED UPON THE USE OF GENUINE GEOWEB MANUFACTURED BY PRESTO GEOSYSTEMS. ANY USE OF THIS DRAWING FOR ANY PRODUCT OTHER THAN THAT MANUFACTURED BY PRESTO GEOSYSTEMS IS STRICTLY PROHIBITED.

		PRESTO® PRODUCTS CO. 670 NORTH PERKINS STREET APPLETON, WI 54914 920-738-1328 WWW.PRESTOGEO.COM	
		GENUINE GEOWEB® 40V - 6 INCH CELLULAR CONFINEMENT SYSTEM PERFORATIONS <small>GEOSYSTEMS®, GEOWEB® AND ATR® ARE REGISTERED TRADEMARKS OF PRESTO PRODUCTS COMPANY.</small>	
DATE	NOVEMBER 2019	FILE NAME	GWGEN6DF.DWG
SCALE	NTS	SHEET	1 © 2011 PRESTO GEOSYSTEMS

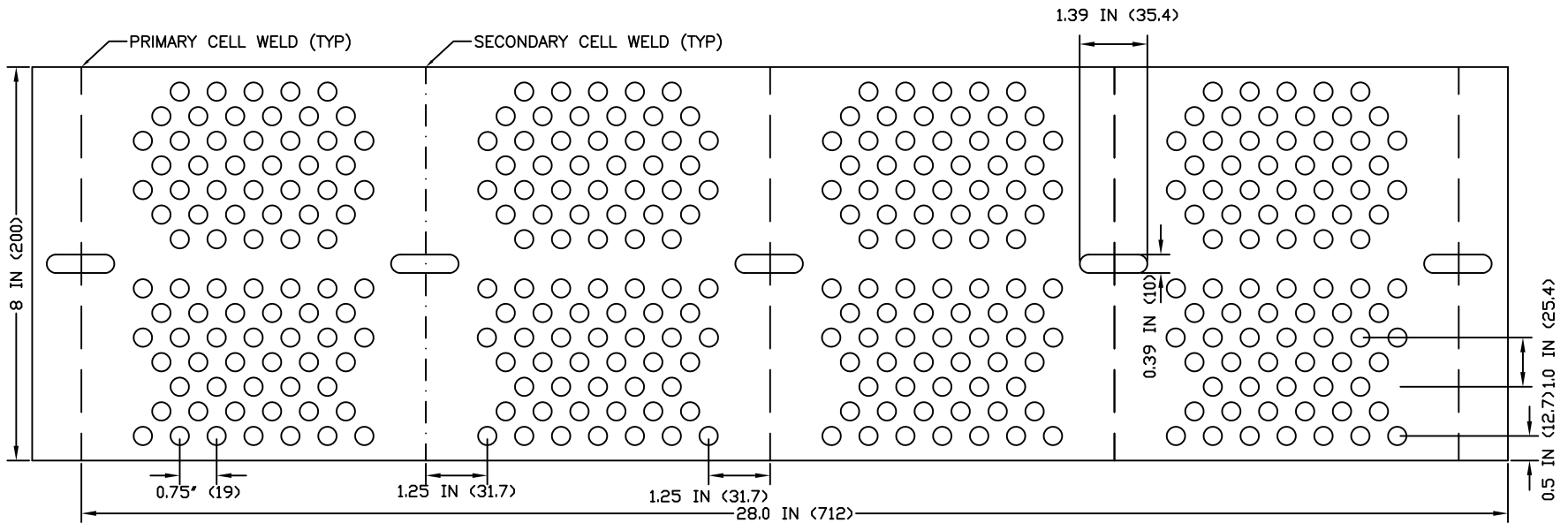

PERFORATION PATTERN - 8 IN (200 MM) COLLAPSED GEOWEB GW40V SECTIONS

NOTES:

1. CENTER I-SLOT ON PRIMARY AND SECONDARY WELDS.
2. ALL PERFORATIONS ARE 0.39" (10MM) DIAMETER.
3. GEOWEB CELL OPEN AREA = 19.8% PLUS/MINUS 1.0%.
4. DIMENSIONS ARE SUBJECT TO MANUFACTURER'S TOLERANCES.
5. DIMENSIONS IN () ARE MILLIMETERS.

GEOWEB CELL DEPTH	# OF PERFORATIONS IN A SINGLE GW20V CELL
8 IN (200 MM)	688
6 IN (150 MM)	496
4 IN (100 MM)	352
3 IN (75 MM)	248

THIS DRAWING IS COPYRIGHTED AND BASED UPON THE USE OF GENUINE GEOWEB MANUFACTURED BY PRESTO GEOSYSTEMS. ANY USE OF THIS DRAWING FOR ANY PRODUCT OTHER THAN THAT MANUFACTURED BY PRESTO GEOSYSTEMS IS STRICTLY PROHIBITED.

		PRESTO[®] PRODUCTS CO. 670 NORTH PERKINS STREET APPLETON, WI 54914 920-738-1328 WWW.PRESTOGEO.COM	
		GENUINE GEOWEB[®] 40V - 8 INCH CELLULAR CONFINEMENT SYSTEM PERFORATIONS <small>GEOSYSTEMS[®] GEOWEB[®] AND ATR[®] ARE REGISTERED TRADEMARKS OF PRESTO PRODUCTS COMPANY.</small>	
DATE	NOVEMBER 2019	FILE NAME	GWGEN6F.DWG
SCALE	NTS	SHEET	1
© 2011 PRESTO GEOSYSTEMS			

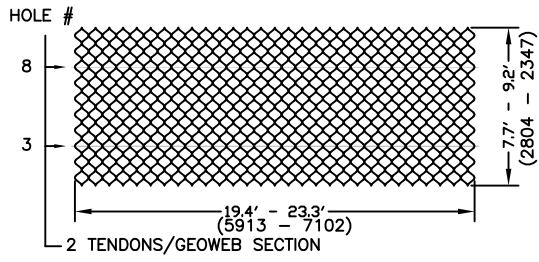

2 TENDON SPACING

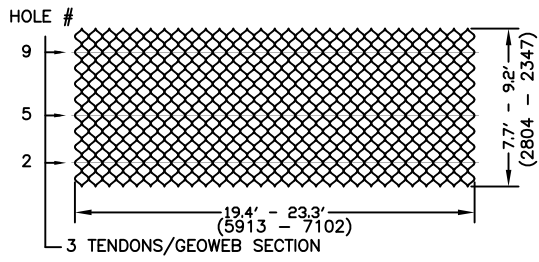

3 TENDON SPACING

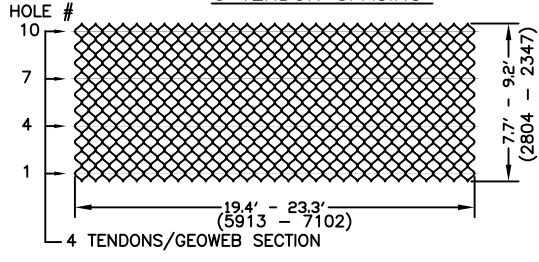

4 TENDON SPACING

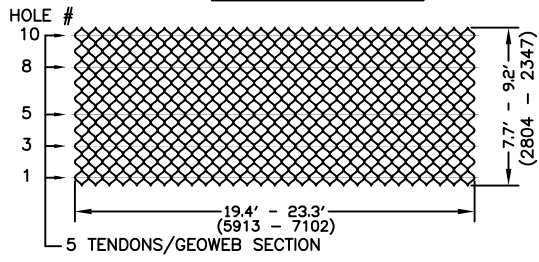

5 TENDON SPACING

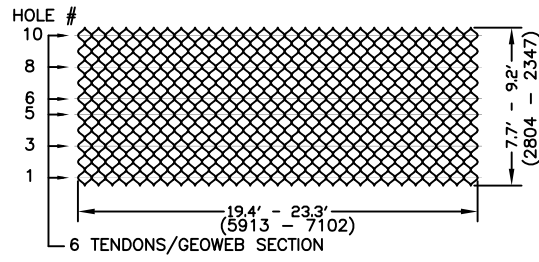

6 TENDON SPACING

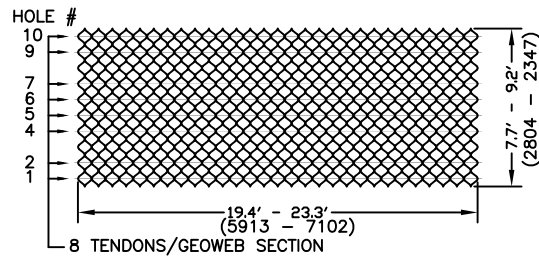

8 TENDON SPACING

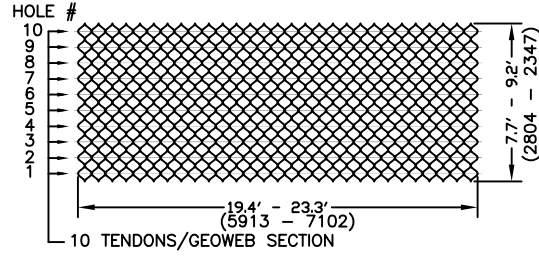

10 TENDON SPACING

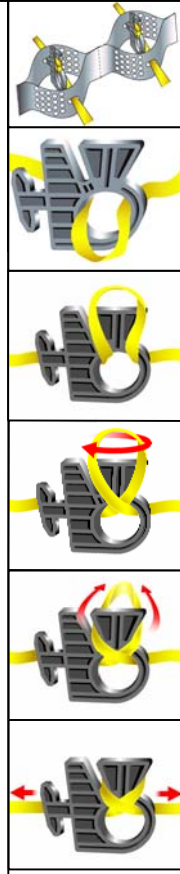

STEP 1: INSERT THE LOCKING MEMBER OF THE ATRA TENDON CLIP THROUGH THE I-SLOT IN THE CELL WALL. TURN THE CLIP 90 DEGREES TO LOCK.

STEP 2: PULL A FEW INCHES OF TENDON THROUGH THE CIRCULAR OPENING IN THE ATRA TENDON CLIP.

STEP 3: PULL THE TENDON UP AND OVER THE POST OF THE ATRA TENDON CLIP.

STEP 4: TWIST THE TENDON TO FORM A LOOP.

STEP 5: FOLD THE TENDON LOOP BACK DOWN OVER THE POST.

STEP 6: PULL THE TENDON SO THE SLACK IS ELIMINATED AND IT IS TIGHTLY SECURED TO THE CLIP.

TYPICAL TENDON TIE OFF DETAIL

	PRESTO® PRODUCTS CO. 670 NORTH PERKINS STREET APPLETON, WI 54914 920-738-1328 WWW.PRESTOGEO.COM
	GENUINE GEOWEB® GW20V TENDON DETAILS

THIS DRAWING IS COPYRIGHTED AND BASED UPON THE USE OF GENUINE GEOWEB MANUFACTURED BY PRESTO GEOSYSTEMS. ANY USE OF THIS DRAWING FOR ANY PRODUCT OTHER THAN THAT MANUFACTURED BY PRESTO GEOSYSTEMS IS STRICTLY PROHIBITED.

PRESTO®, GEOWEB®, AND ATRA® ARE REGISTERED TRADEMARKS OF PRESTO PRODUCTS.	
DATE	NOVEMBER 2019
SCALE	NTS
FILE NAME	GWGEN7F.DWG
SHEET	1
© 2010 PRESTO GEOSYSTEMS	

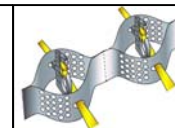
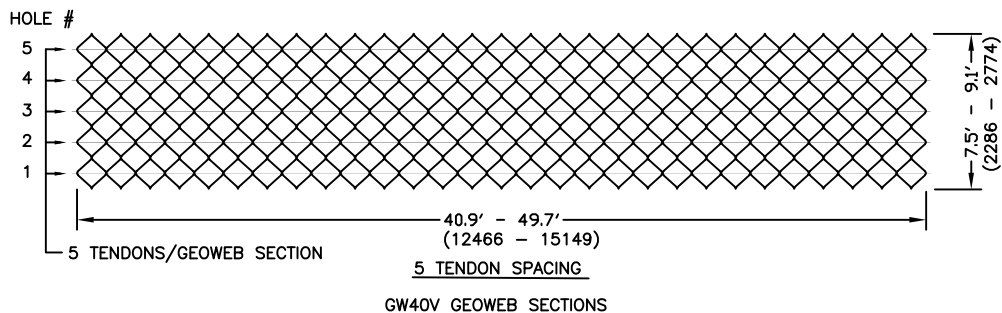
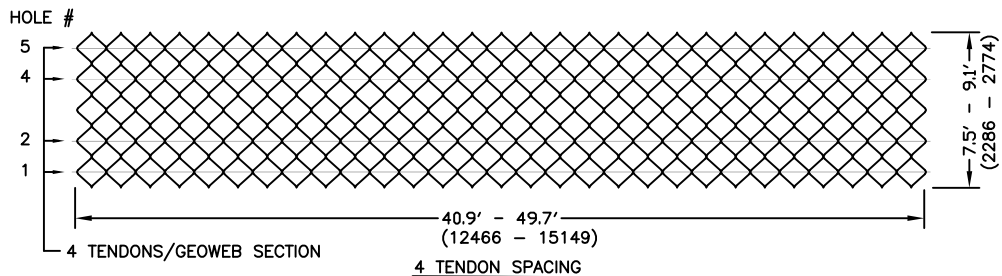
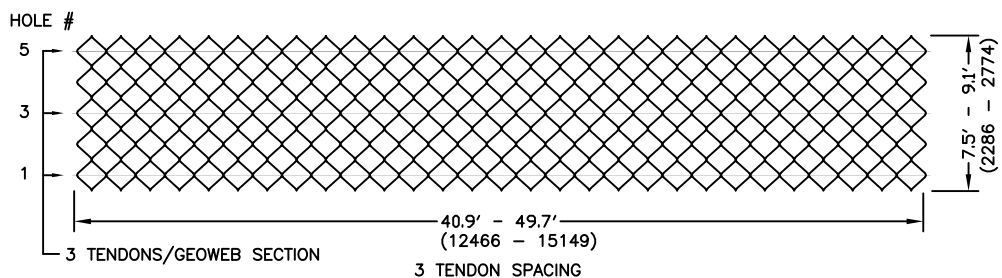
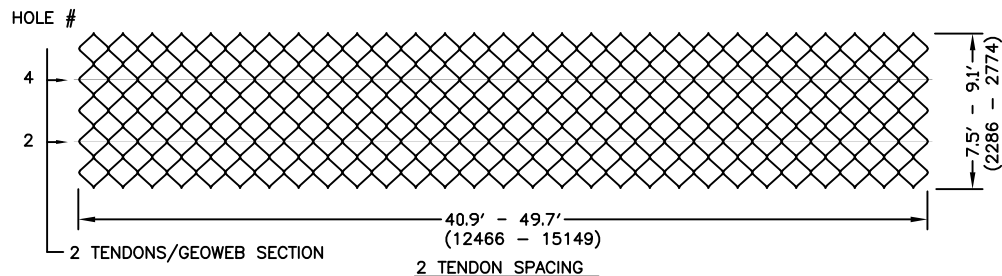

STEP 1: INSERT THE LOCKING MEMBER OF THE ATRA TENDON CLIP THROUGH THE 1-SLOT IN THE CELL WALL. TURN THE CLIP 90 DEGREES TO LOCK.



STEP 2: PULL A FEW INCHES OF TENDON THROUGH THE CIRCULAR OPENING IN THE ATRA TENDON CLIP.



STEP 3: PULL THE TENDON UP AND OVER THE POST OF THE ATRA TENDON CLIP.



STEP 4: TWIST THE TENDON TO FORM A LOOP.



STEP 5: FOLD THE TENDON LOOP BACK DOWN OVER THE POST.



STEP 6: PULL THE TENDON SO THE SLACK IS ELIMINATED AND IT IS TIGHTLY SECURED TO THE CLIP.

TYPICAL TENDON TIE OFF DETAIL



PRESTO® PRODUCTS CO.
670 NORTH PERKINS STREET
APPLETON, WI 54914
920-738-1328
WWW.PRESTOGEO.COM

THIS DRAWING IS COPYRIGHTED AND BASED UPON THE USE OF GENUINE GEOWEB MANUFACTURED BY PRESTO GEOSYSTEMS. ANY USE OF THIS DRAWING FOR ANY PRODUCT OTHER THAN THAT MANUFACTURED BY PRESTO GEOSYSTEMS IS STRICTLY PROHIBITED.

GENUINE GEOWEB®
GW40V TENDON DETAILS

PRESTO®, GEOWEB®, AND ATRA® ARE REGISTERED TRADEMARKS OF PRESTO PRODUCTS.

DATE	NOVEMBER 2019	FILE NAME	GWGENBF.DWG
SCALE	NTS	SHEET	1

© 2010 PRESTO GEOSYSTEMS

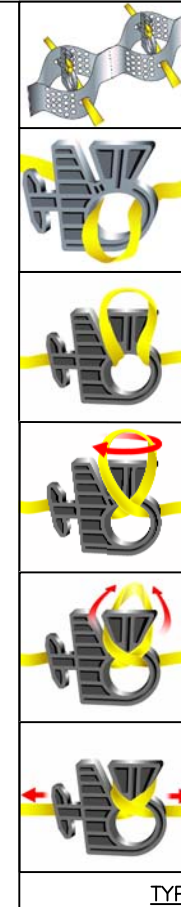
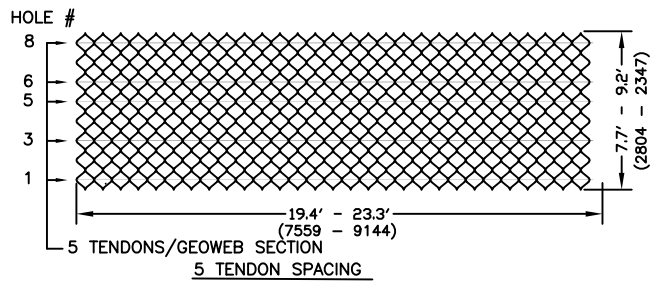
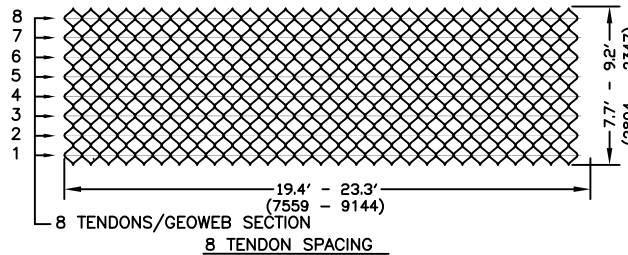
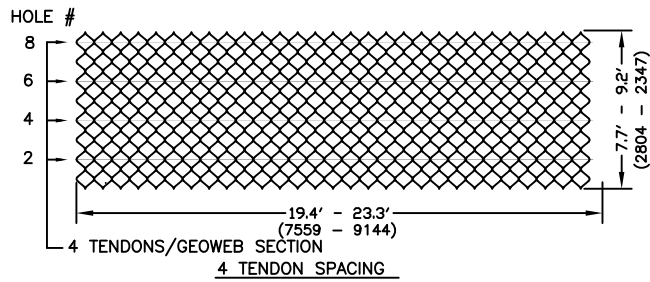
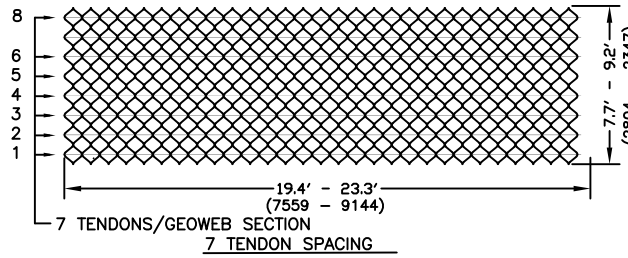
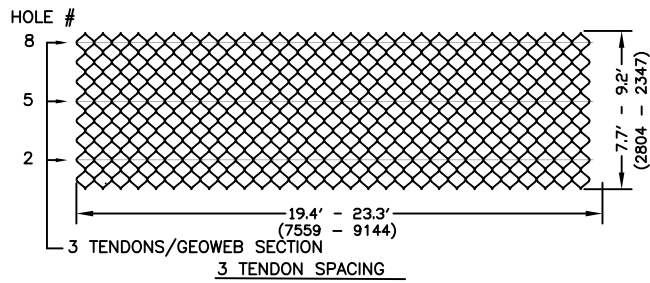
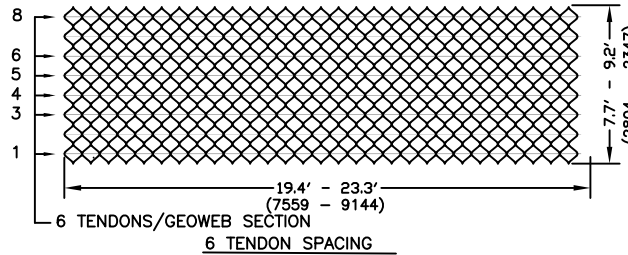
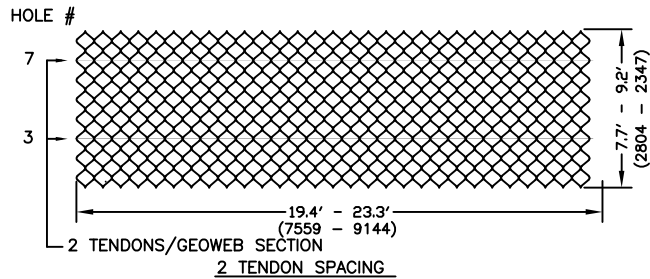

STEP 1: INSERT THE LOCKING MEMBER OF THE ATRA TENDON CLIP THROUGH THE 1-SLOT IN THE CELL WALL. TURN THE CLIP 90 DEGREES TO LOCK.

STEP 2: PULL A FEW INCHES OF TENDON THROUGH THE CIRCULAR OPENING IN THE ATRA TENDON CLIP.

STEP 3: PULL THE TENDON UP AND OVER THE POST OF THE ATRA TENDON CLIP.

STEP 4: TWIST THE TENDON TO FORM A LOOP.

STEP 5: FOLD THE TENDON LOOP BACK DOWN OVER THE POST.

STEP 6: PULL THE TENDON SO THE SLACK IS ELIMINATED AND IT IS TIGHTLY SECURED TO THE CLIP.

TYPICAL TENDON TIE OFF DETAIL



PRESTO® PRODUCTS CO.
670 NORTH PERKINS STREET
APPLETON, WI 54914
920-738-1328
WWW.PRESTOGEO.COM

THIS DRAWING IS COPYRIGHTED AND BASED UPON THE USE OF GENUINE GEOWEB MANUFACTURED BY PRESTO GEOSYSTEMS. ANY USE OF THIS DRAWING FOR ANY PRODUCT OTHER THAN THAT MANUFACTURED BY PRESTO GEOSYSTEMS IS STRICTLY PROHIBITED.

GENUINE GEOWEB®
GW30V TENDON DETAILS

PRESTO®, GEOWEB®, AND ATRA® ARE REGISTERED TRADEMARKS OF PRESTO PRODUCTS.

DATE	NOVEMBER 2019	FILE NAME	GWGEN9F.DWG
SCALE	NTS	SHEET	1
© 2010 PRESTO GEOSYSTEMS			

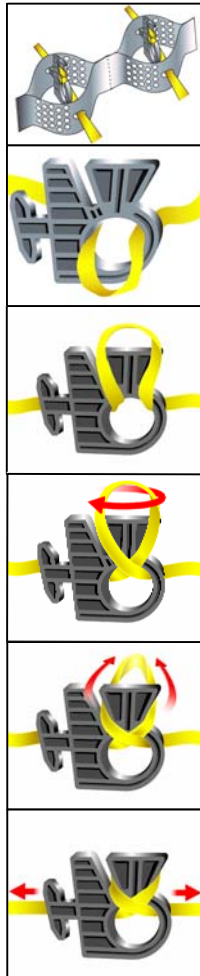

STEP 1: INSERT THE LOCKING MEMBER OF THE ATRA TENDON CLIP THROUGH THE I-SLOT IN THE CELL WALL. TURN THE CLIP 90 DEGREES TO LOCK.

STEP 2: PULL A FEW INCHES OF TENDON THROUGH THE CIRCULAR OPENING IN THE ATRA TENDON CLIP.

STEP 3: PULL THE TENDON UP AND OVER THE POST OF THE ATRA TENDON CLIP.

STEP 4: TWIST THE TENDON TO FORM A LOOP.

STEP 5: FOLD THE TENDON LOOP BACK DOWN OVER THE POST.

STEP 6: PULL THE TENDON SO THE SLACK IS ELIMINATED AND IT IS TIGHTLY SECURED TO THE CLIP.

	PRESTO® PRODUCTS CO. 670 NORTH PERKINS STREET APPLETON, WI 54914 920-738-1328 WWW.PRESTOGEOSYSTEMS.COM		
	ATRA® TENDON CLIP TIE OFF DETAIL		
<small>PRESTO®, GEOWEB®, AND ATRA® ARE REGISTERED TRADEMARKS OF PRESTO PRODUCTS.</small>			
DATE	JUNE 2013	FILE NAME	GWGEN10F.DWG
SCALE	NTS	SHEET	1 © 2010 PRESTO GEOSYSTEMS

THIS DRAWING IS COPYRIGHTED AND BASED UPON THE USE OF GENUINE GEOWEB MANUFACTURED BY PRESTO GEOSYSTEMS. ANY USE OF THIS DRAWING FOR ANY PRODUCT OTHER THAN THAT MANUFACTURED BY PRESTO GEOSYSTEMS IS STRICTLY PROHIBITED.

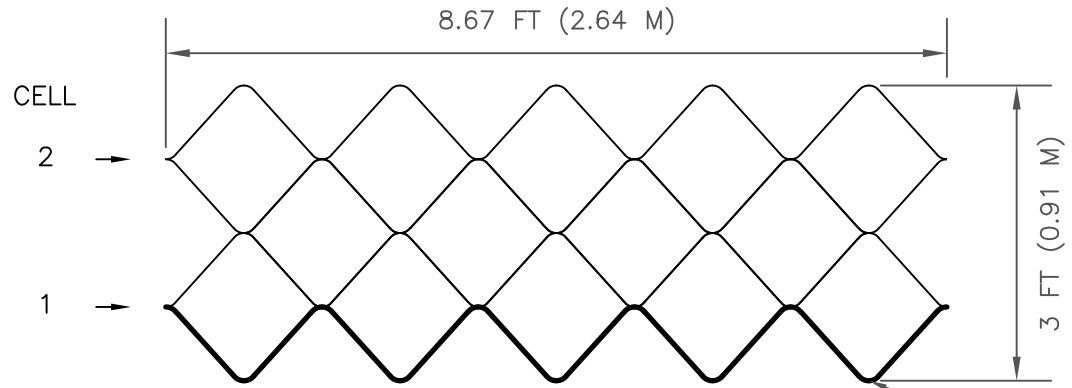

GW40V12 - 2 CELL WALL SECTION

NON PERFORATED FRONT FACE (TYP)

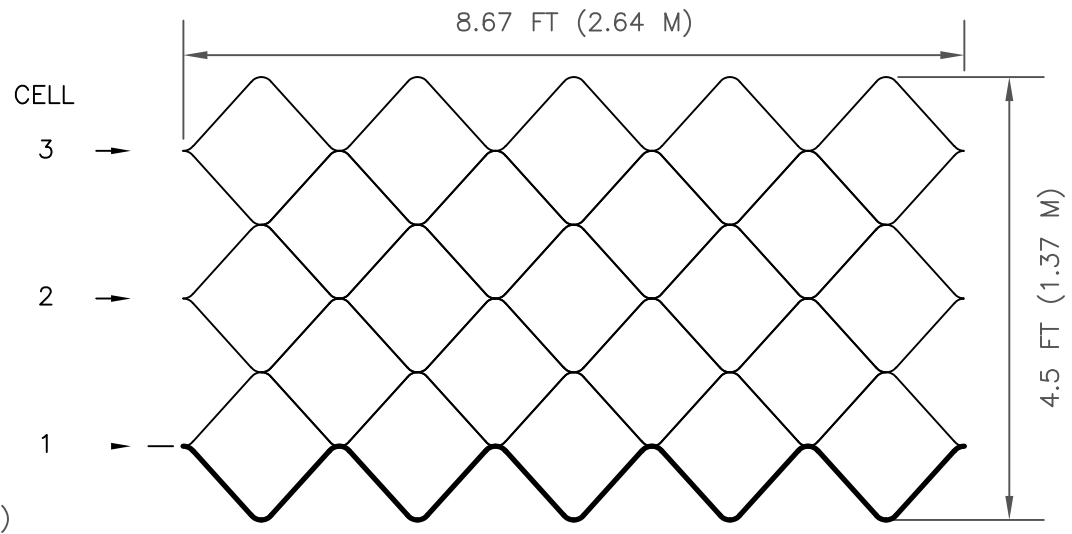

GW40V12 - 3 CELL WALL SECTION

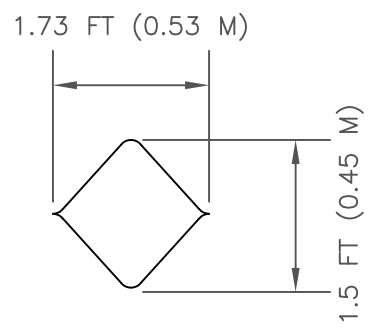

GW40V12 - SINGLE CELL

	PRESTO® PRODUCTS CO. 670 NORTH PERKINS STREET APPLETON, WI 54914 920-738-1328 WWW.PRESTOGEO.COM
	GENUINE GEOWEB® GW40V12 WALL SECTIONS

THIS DRAWING IS COPYRIGHTED AND BASED UPON THE USE OF GENUINE GEOWEB MANUFACTURED BY PRESTO GEOSYSTEMS. ANY USE OF THIS DRAWING FOR ANY PRODUCT OTHER THAN THAT MANUFACTURED BY PRESTO GEOSYSTEMS IS STRICTLY PROHIBITED.		PRESTO®, GEOWEB®, AND ATRA® ARE REGISTERED TRADEMARKS OF PRESTO PRODUCTS.	
DATE	NOVEMBER 2019	FILE NAME	GWGEN11F.DWG
SCALE	NTS	SHEET	1 © 2010 PRESTO GEOSYSTEMS

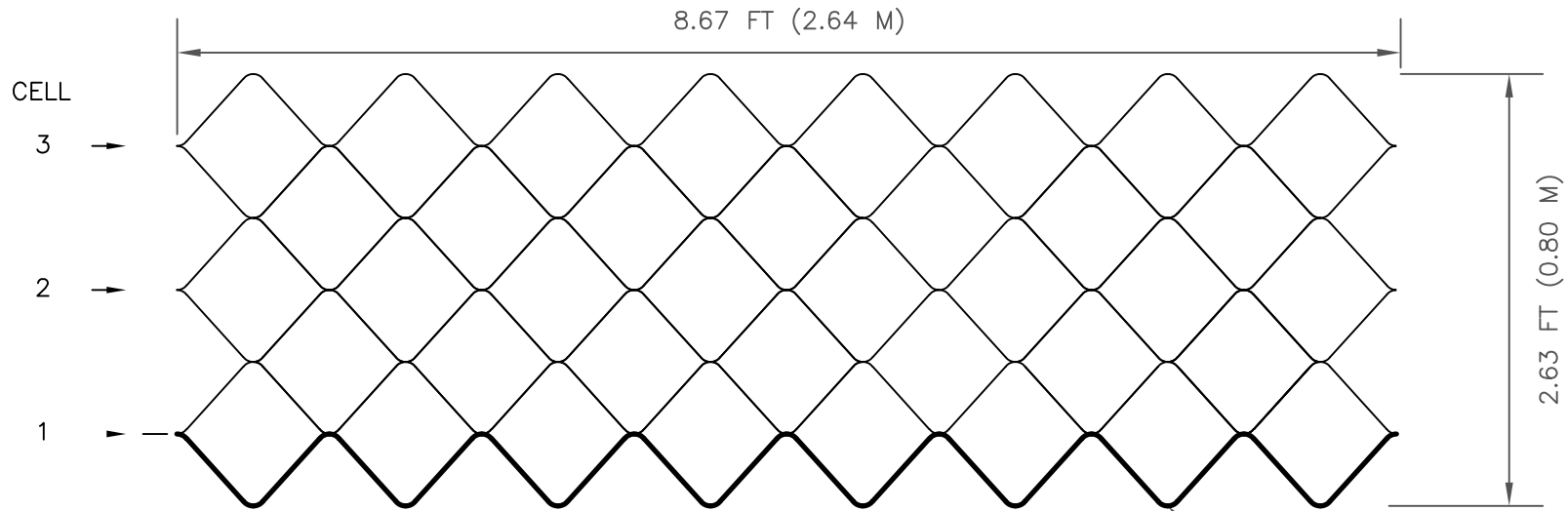

GW30V6 – 3 CELL WALL SECTION

NON PERFORATED FRONT FACE (TYP)

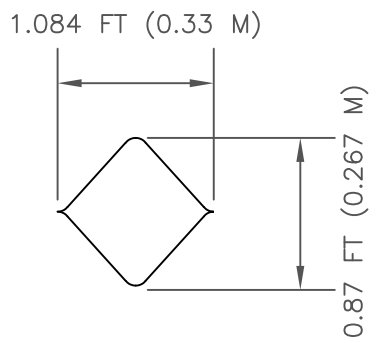

APPROXIMATE DIMENSIONS
GW30V6 – SINGLE CELL



PRESTO[®] PRODUCTS CO.
670 NORTH PERKINS STREET
APPLETON, WI 54914
920-738-1328
WWW.PRESTOGEO.COM

<p>THIS DRAWING IS COPYRIGHTED AND BASED UPON THE USE OF GENUINE GEOWEB MANUFACTURED BY PRESTO GEOSYSTEMS. ANY USE OF THIS DRAWING FOR ANY PRODUCT OTHER THAN THAT MANUFACTURED BY PRESTO GEOSYSTEMS IS STRICTLY PROHIBITED.</p>		<p>GENUINE GEOWEB[®] GW30V6, 3 CELL WALL SECTIONS</p>	
		<p>PRESTO[®], GEOWEB[®], AND ATRA[®] ARE REGISTERED TRADEMARKS OF PRESTO PRODUCTS.</p>	
DATE	NOVEMBER 2019	FILE NAME	GWGEN12F.DWG
SCALE	NTS	SHEET	1 © 2010 PRESTO GEOSYSTEMS

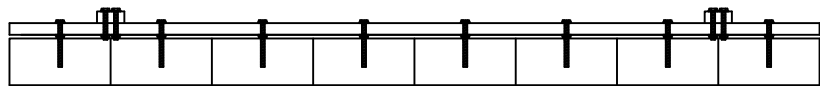
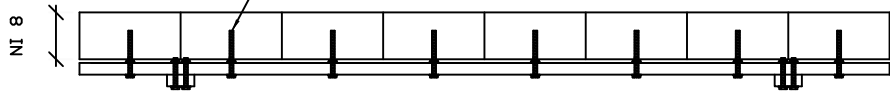
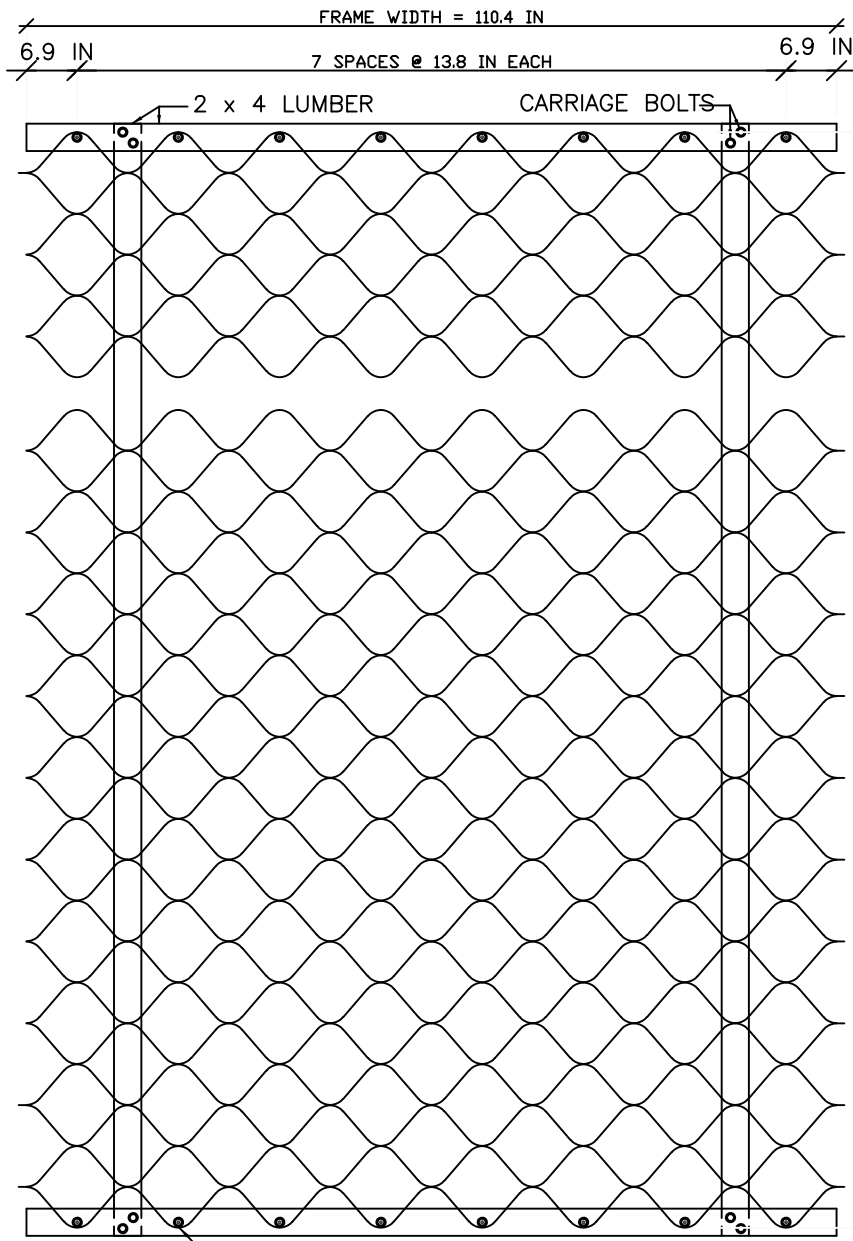

PARTS LIST - WOOD STRETCHER FRAME

- 16 - 7/16" X 9" CARRIAGE BOLTS
- 8 - 7/16" X 4" CARRIAGE BOLTS
- 24 - 7/16" FLAT WASHERS
- 24 - 7/16" HEX NUTS
- 2 - 2" X 4" X 110.4" LUMBER
- 2 - 2" X 4" X 24.8' LUMBER

	PRESTO PRODUCTS CO. 670 NORTH PERKINS STREET APPLETON, WI 54914 920-738-1342 WWW.PRESTOGEO.COM
	GENUINE GEOWEB® 29 CELL WOODEN STRETCHER FRAME
<small>PRESTO®, GEOWEB®, AND ATRA® ARE REGISTERED TRADEMARKS OF PRESTO PRODUCTS.</small>	
<small>FILE NAME 30V-29 stretcher frame</small>	<small>DATE NOVEMBER 2019</small>
<small>SCALE NTS</small>	<small>SHEET 1 © 2010 PRESTO GEOSYSTEMS</small>

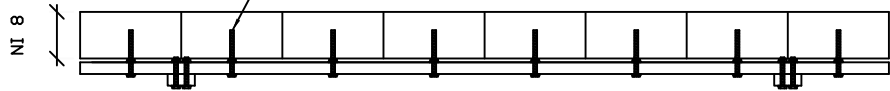
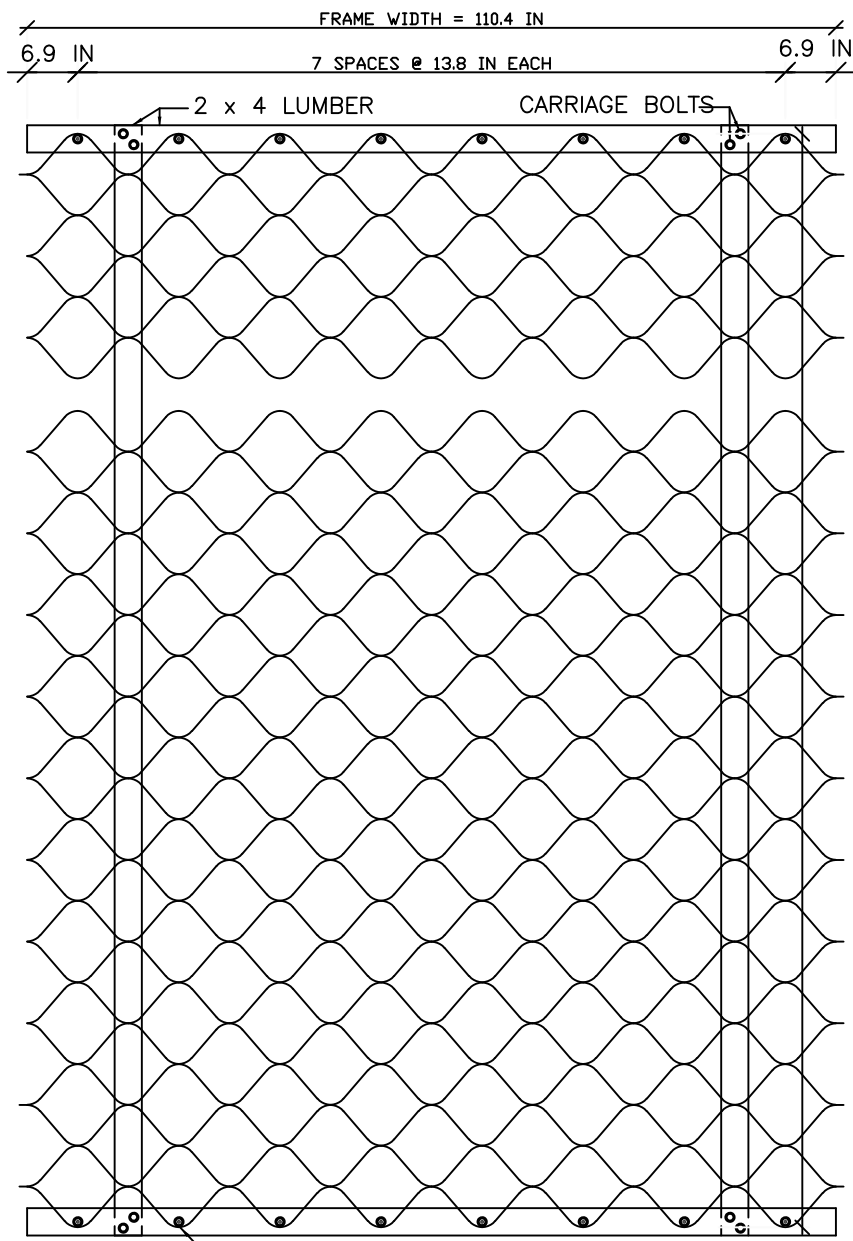

SIDE VIEW - UPSIDE DOWN FOR EXPANSION OF GEOWEB SECTION

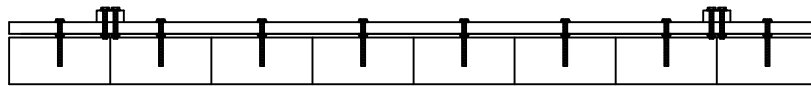

SIDE VIEW - TURNED OVER FOR PLACEMENT OF GEOWEB SECTION

PARTS LIST - WOOD STRETCHER FRAME

- 16 - $\frac{7}{16}$ " X 9" CARRIAGE BOLTS
- 8 - $\frac{7}{16}$ " X 4" CARRIAGE BOLTS
- 24 - $\frac{7}{16}$ " FLAT WASHERS
- 24 - $\frac{7}{16}$ " HEX NUTS
- 2 - 2" X 4" X 110.4" LUMBER
- 2 - 2" X 4" X 29.3' LUMBER

	PRESTO PRODUCTS CO. 670 NORTH PERKINS STREET APPLETON, WI 54914 920-738-1342 WWW.PRESTOGEOD.COM
	GENUINE GEOWEB 34[®] CELL WOODEN STRETCHER FRAME
<small>PRESTO[®], GEOWEB[®], AND ATRA[®] ARE REGISTERED TRADEMARKS OF PRESTO PRODUCTS.</small>	
<small>FILE NAME 30V-34 stretcher frame</small>	<small>DATE NOVEMBER 2019</small>
<small>SCALE NTS</small>	<small>SHEET 1 © 2010 PRESTD GEOSYSTEMS</small>